

# PRODUCT SHEET: CC40

## Acoustic Suspension Hangers

CC40 Elastomer Acoustic Suspension Hangers have been designed to suspend acoustic ceilings using 47mm standard profile (or Profile-U47/17-3000), improving airborne isolation performance.

### SYSTEM FEATURES:

- 🔊 Cost effective
- 🔊 Quick and easy to install
- 🔊 Hangers can be ordered in two different stiffnesses:
  - CC40-150 10-20 kg per hanger
  - CC40-350 20-45 kg per hanger
- 🔊 Natural frequency between 12 and 18Hz
- 🔊 Failsafe easily engaged - as shown
- 🔊 System comes optional with an elastomer washer to allow direct fixation to the ceiling
- 🔊 Variable void depths are achievable (CDM-CC40 hanger depth is 40mm)
- 🔊 Steel elements are Zinc plated
- 🔊 For optimum results resilient perimeter strips should be used to provide lateral isolation between the suspended ceiling and adjacent walls. A wide range of roll sizes are available.

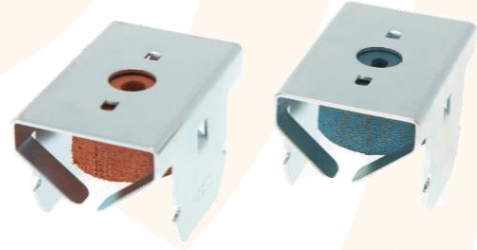

### REQUIREMENTS

To specify which CC40 hangers you require our engineers will need the following information:

- 🔊 The weight and construction of the supported ceiling - this will determine the type of hanger
- 🔊 The required void between the supporting soffit and the suspended ceiling.

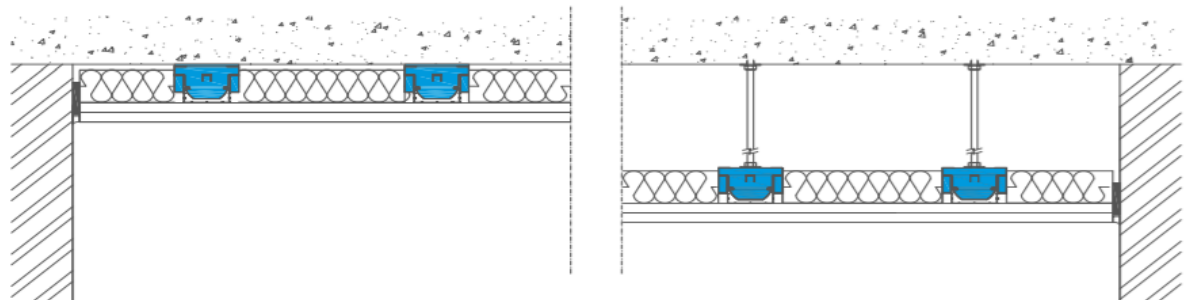

# PRODUCT SHEET: CC60

## Acoustic Suspension Hangers

CC60 Elastomer Acoustic Suspension Hangers have been designed to suspend acoustic ceilings using 60mm standard profile (or Profile-C60/27-2000), improving airborne isolation performance.

### SYSTEM FEATURES:

- » Cost effective
- » Quick and easy to install
- » Standard hangers are:
  - CC60-150      10-20 kg per hanger
  - CC60-350      20-45 kg per hanger
- » Natural frequency between 12 and 18Hz
- » System comes optional with an elastomer washer to allow direct fixation to the ceiling
- » Variable void depths are achievable (CC60 hanger depth is 47mm)
- » Steel elements are Zinc plated
- » For optimum results resilient perimeter strips should be used to provide lateral isolation between the suspended ceiling and adjacent walls. A wide range of roll sizes are available.



### REQUIREMENTS

To specify which CC60 hangers you require our engineers will need the following information:

- » The weight and construction of the supported ceiling - this will determine the type of hanger
- » The required void between the supporting soffit and the suspended ceiling

